

exploring Resin JEWELRY-MAKING

with Susan Lenart Kazmer



MATERIALS

- 1 brass 5mm heishi spacer
- 1 sterling silver 32×55mm backless 2-loop bezel pendant
- 1 sterling silver 9×16mm lobster clasp with attached 7mm jump ring
- 1 purple lampworked-squiggle head pin
- 1 sterling silver 10mm jump ring
- 18" of sterling silver 4×5mm oval chain
- 5" of sterling silver 16-gauge wire
- 3" of sterling silver 20-gauge wire
- 5" of silk organza, torn into a 15mm wide strip
- 1 dried pressed flower
- 1 small dry stick (about ¼×4")
- 1 small piece of scrap paper with words or numbers
- 2-part epoxy resin
- 3×3" piece of contact paper or very sticky tape
- extra-fine (#0000) steel wool
- plastic garbage bag

TOOLS

- small disposable plastic measuring cup
- Popsicle stick
- task light
- small disposable paintbrush
- wire cutters
- steel bench block
- chasing hammer
- pencil
- round-nose pliers
- scissors
- 2 pairs of chain- or flat-nose pliers

MAKE THE PENDANT

1: Prepare the bezel: Remove the backing from the contact paper (fig. 1) and place it, tacky side up, on your work surface. Place the bezel, right side up, on top of the contact paper (fig. 2). Use your fingers to gently burnish the nonsticky side of the contact paper, where it comes in contact with the bezel, to encourage adherence (fig. 3). Set the bezel aside, right side up.

2: Mix the resin: Pour ¼ oz Part A resin into the plastic measuring cup, then pour ¼ oz Part B resin into the measuring cup (fig. 4). Use the Popsicle stick to gently fold the two parts of resin into each other, mixing until smooth, about 2 minutes (fig. 5). This batch of resin will be useful for 30 minutes.

3: Insert the dried flower and paper into the bezel: Use the Popsicle stick to drizzle a thin layer of the resin mixture into the bezel (fig. 6), then arrange the dried flower and scrap of paper as desired on top of the resin layer. Drizzle more resin into the bezel until you completely fill it, but don't let it overflow (fig. 7). Place a task light over the bezel to help release any air bubbles that might have formed in the resin. Let dry for at least 6 hours.

4: Coat the stick with resin: While the resin in the bezel is drying, use the paintbrush to apply a thick coat of resin to the entire stick (fig. 8). Let dry on the garbage bag.

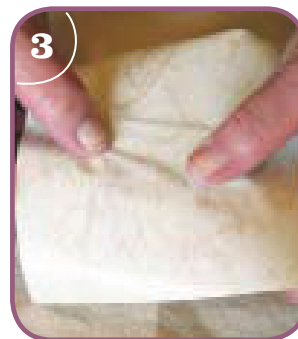
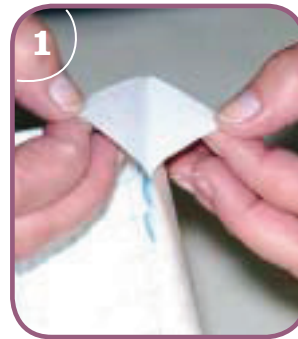

TIP: Discard all tools used for mixing resin when finished—the plastic measuring cup, the Popsicle stick, and the paintbrush.

5: Finish filling the bezel: Use the Popsicle stick to drizzle resin into the bezel carefully until it domes. Let dry and cure completely at about 72°F in a dust-free area. This will take 3 full days. Do not touch the resin until it is completely dry or you'll risk leaving fingerprints.

6: Recoat the stick: Use the paintbrush to apply another coat of resin to the stick. Let dry.

7: Clean up the bezel and stick: After the resin in the bezel has cured, remove the contact paper. If necessary, use wire cutters to remove resin "burrs" on the stick, then go over the stick with steel wool to soften the shine of the resin (fig. 9).

8: Create a hammered-wire coil: Place the 16-gauge wire on the steel block and use the ball end of the chasing hammer to flatten it. Wrap the flattened wire around the pencil (or any other dowel or round object that is similar in circumference to the stick). Wrap the coiled wire around the stick, using round-nose pliers to coax the wire if necessary; stop when you reach the middle of the stick (fig. 10). Use the flattened wire to string the top loop of the bezel pendant and the middle link of the chain, then finish wrapping the coiled wire around the stick.

ASSEMBLE THE NECKLACE

9: Attach the silk: Wrap the silk around the center of the branch and the center of the chain, leaving a 1" tail on each end of the silk (fig. 11). Tie an overhand knot.

10: Attach a dangle to the pendant: Form a wrapped loop on the lampworked-squiggle head pin to make a dangle. Use the 20-gauge wire to form a long wrapped loop that attaches to the dangle. String the heishi spacer, then form a long wrapped loop that attaches to the bottom loop of the bezel pendant (fig. 12).

11: Add the clasp: Attach the jump ring attached to the lobster clasp to one end of the chain. Attach the 10mm jump ring to the other end of the chain.

TIPS: It's important to mix equal parts of Part A resin with Part B resin. Always mix at least ½ oz of resin (¼ oz each part) at one time or curing problems will arise.

The optimal temperature for mixing resin is 72°F. Cooler temperatures may cause difficulty in blending and getting rid of bubbles.

